

INTEGRATED DESIGN FOR BEST PERFORMANCE
明心設計，只為最佳效能

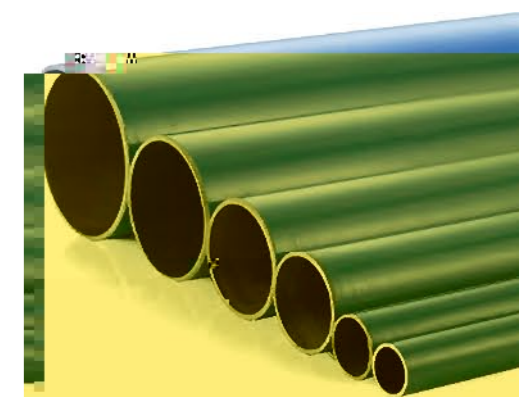



Superior Reliability & Longevity 最佳可靠性和使用年限

- U
- M
- P
- E
- R
- T

Quick & Easy Modular Installation 便捷的模組化安裝

- C
- R
- R
- Q
- E
- T

Energy & Cost Savings 成本更效能節省 最低使用成本

- T
- C
- R
- E
- T

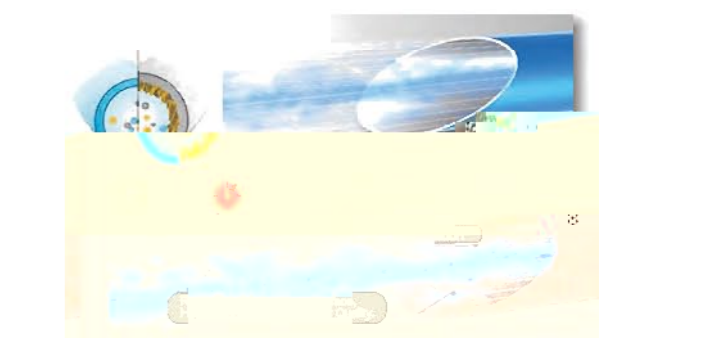

www.airpipe.tech.com

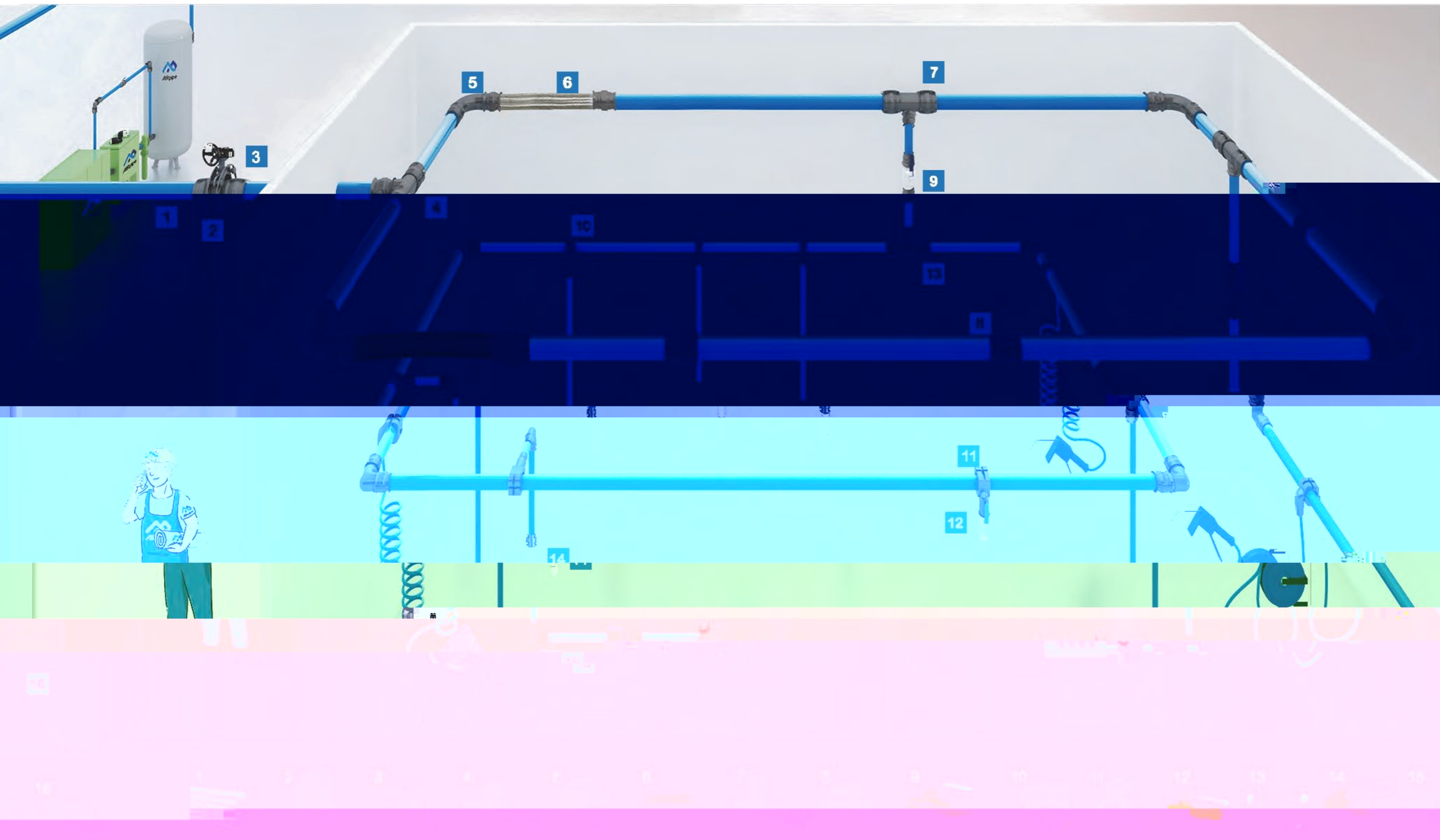

- | | | | |
|---|----------------|---|---|
| 1 | 5 ^A | 5 | 5 |
| 2 | 6 ^F | 6 | 6 |
| 3 | 7 ^F | 7 | 7 |
| 4 | 8 ^F | 8 | 8 |

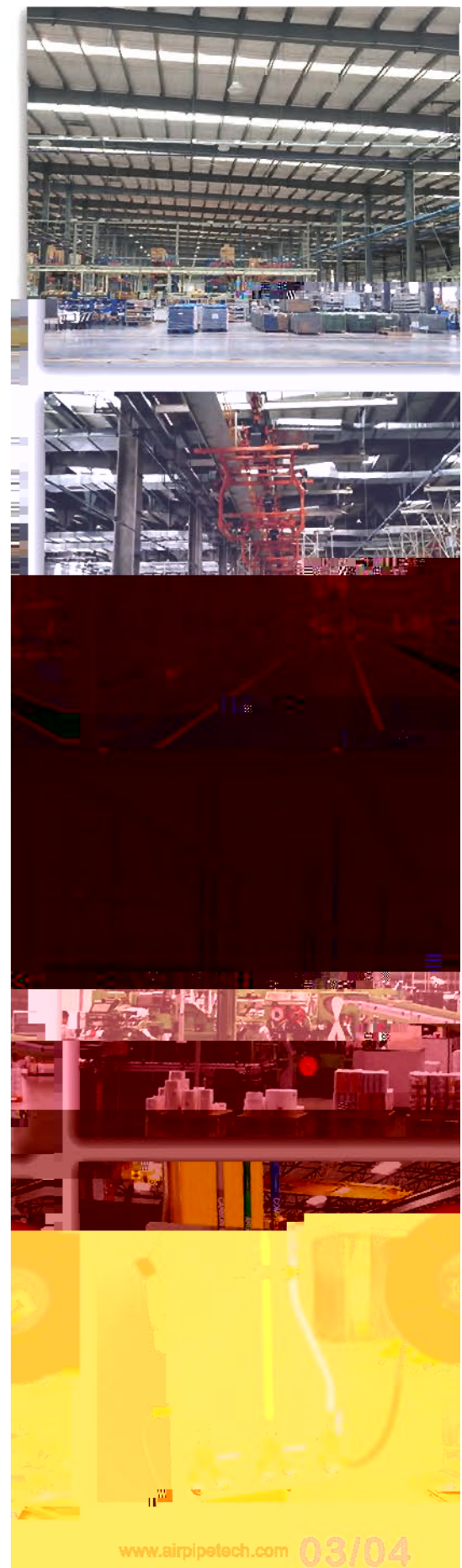

Product Range & Features

產品範圍和特性

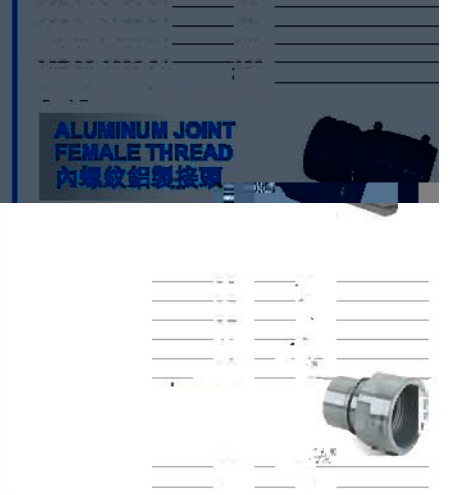
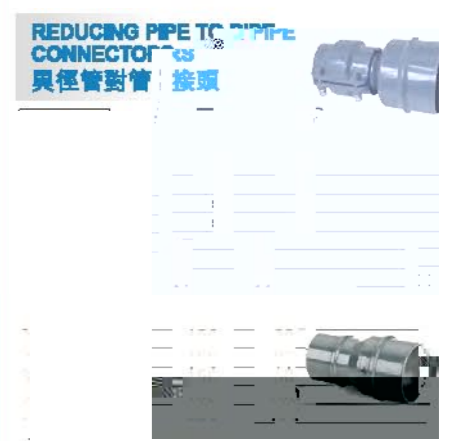
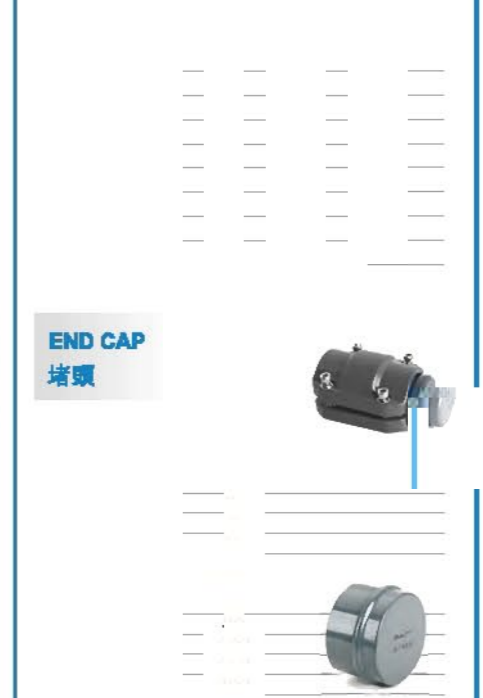
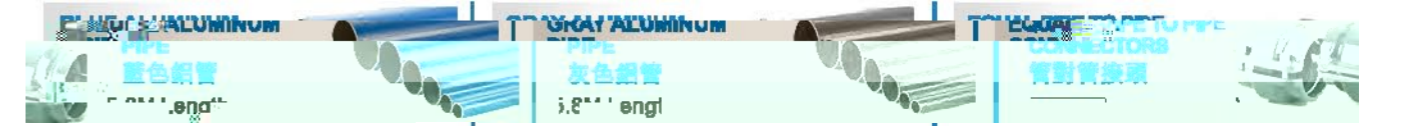
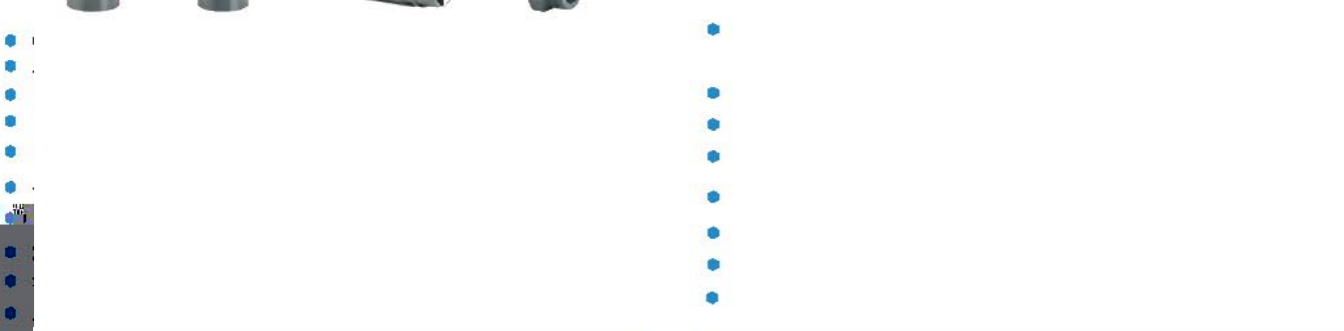
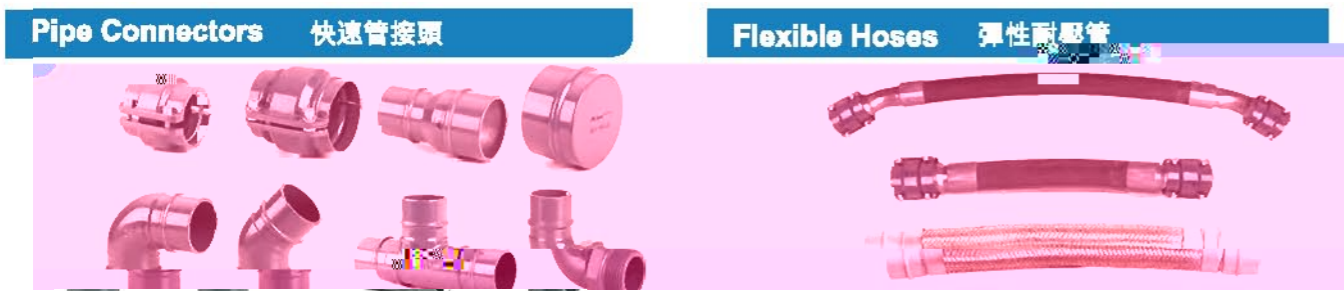

FIXTURE CLAMPS & ACCESSORIES
管夾



THREADED ADAPTORS
轉接頭



ATMOLYSIS BAG
分解氣袋



ALUMINUM PIPE DEBURRER
鋁管去毛刺器



ADJUSTABLE BRACKET
可伸縮支架



WALL MOUNTED BRACKET
懸臂支架



SPANNERS
水泵鉗



GRIDER CLAMP
老虎鉗



UNIVERSAL BEAM SUSPENDER
外向抱箍吊扣



ALUMINUM PIPE CUTTER
鋁管切割器



SQUARE STEEL CLAMP
壓板



FIXTURE CLAMPS & ACCESSORIES
萬向抱箍



CLAMP SPA
管夾墊

CSB

VORTEX FL
渦街流量計

QW

TOOL BOX
工具包



DRILL HOLDER
鑽頭夾具



PRESSURE
氣體壓力錶

PMETER



MARKER
標記器



HOLE DEBURRER
去毛刺器



ELECTRIC PIPE CUTTER
電動鋁管切割機



FIXING BOLTS
螺栓



SQUARE STEEL
方鋼



PIPE BENDING
彎管

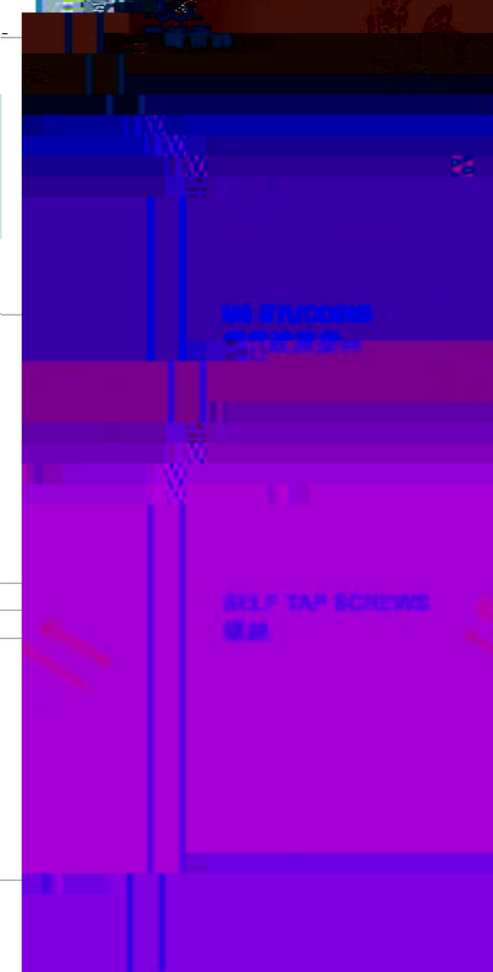

WIRE SUSPENSION CABLE
鋼絲繩



DRILLING MACHINE
鑽機



Superior Reliability!

最佳可靠性



Insertion Depth S For DN20-DN50 Connector
DN20-DN50 (3/4" - 2") 管路安裝插入深度S

DN	Insertion depth S (mm)	插入深度S (mm)
50		39

•	•
•	•

Installation Guide for DN20-DN50 安裝指導DN20-DN50 (3/4" - 2")

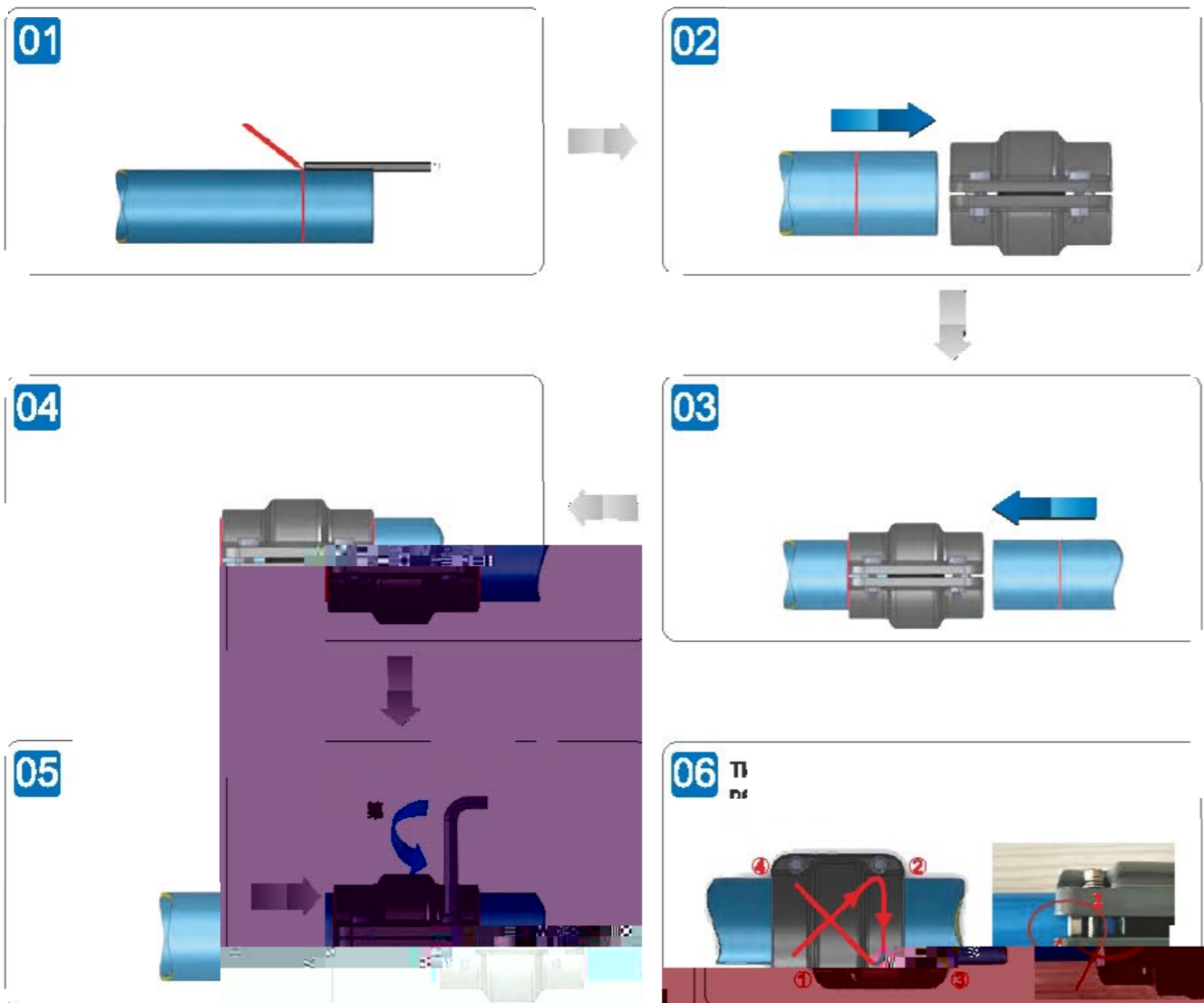

Deburr & Chamfer The Outer and Inner Edges Before Installation
安裝前去除管端切口內外的毛邊

-
-



Installation Guide for DN63-DN200 安裝指導DN63-DN200 (2-3/4" - 8")

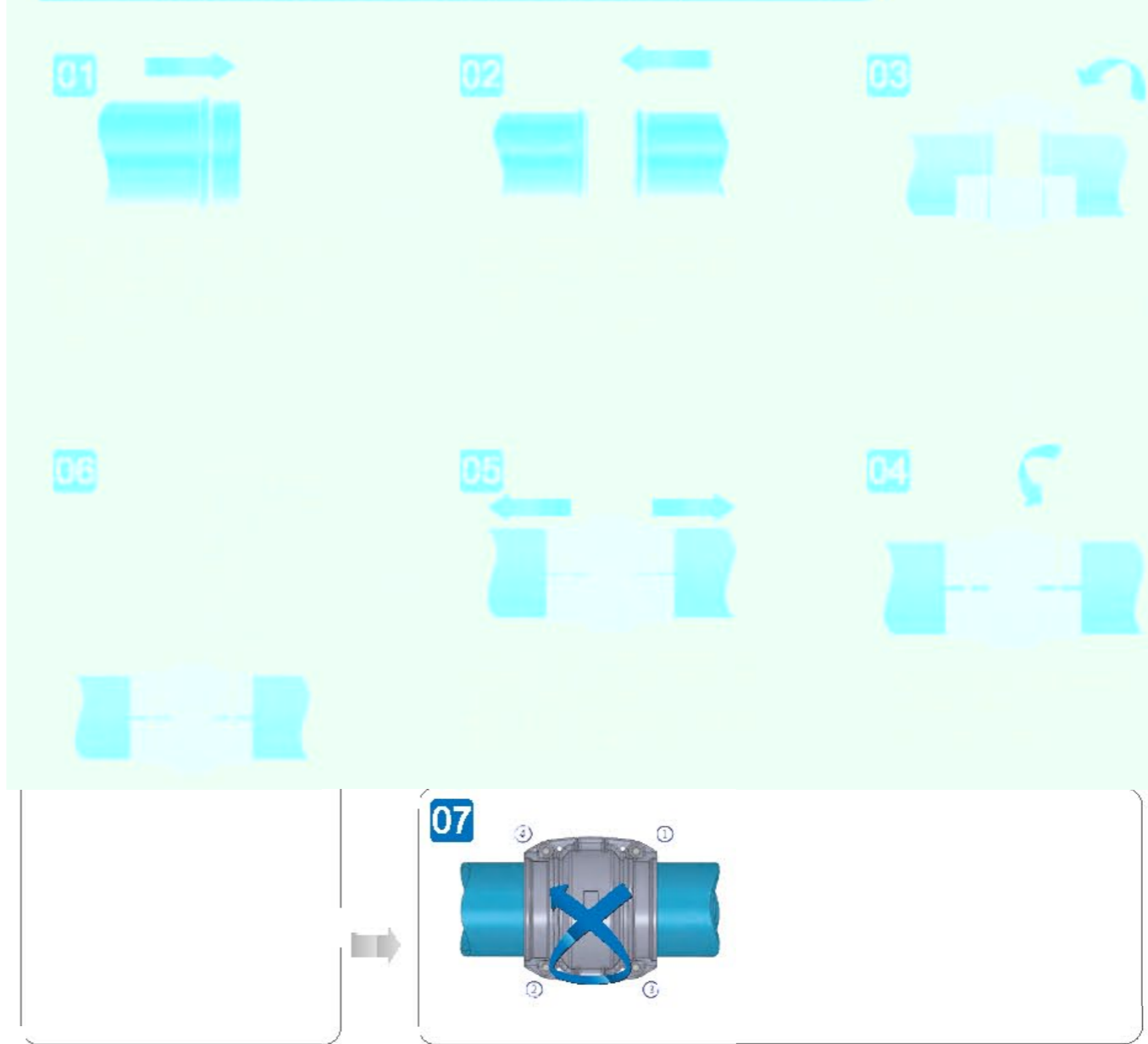

Hand-held hydraulic lugging machine operation requirements 手持液壓凸管器作業要求

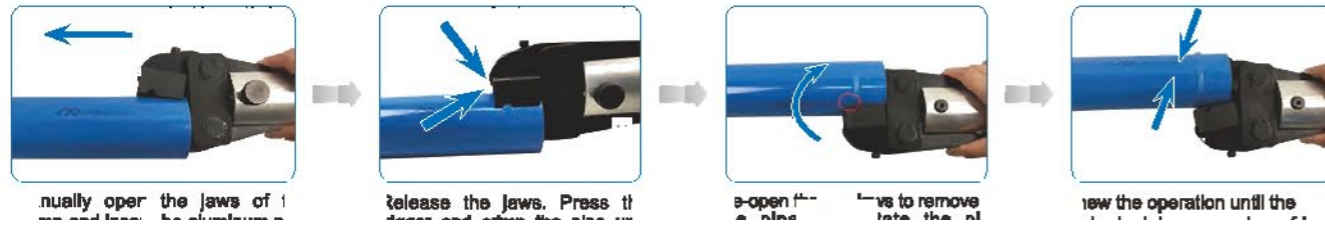

Number of lugs for each diameter: 各規格凸管數

AIRPIPE DN83 DN90 DN100 DN150 DN200

Note: Do not overlap the lugs

DN	H(mm)
83	

(Min.) (Max.)

Sizing Chart for Quick Drops 快換尺寸表

Drill Bit Size	Drill Holder	DN(MM)	Quick Drops (PN)	快換 (PN)
301 35 0005 01	301 35 0005 01			
11 35 0005 02	301 35 0006 05	Φ61	302 10 1004 01	302 10 1005 01
			302 10 1104 01	302 10 1106 01

Flow 管流速度 N m ³ /h	50M	100M	150M	200M	300M	500M	750M	1000M	1500M	2000M
20	20	20	20	20	20	20	20	20	20	20
30	30	30	30	30	30	30	30	30	30	30
40	40	40	40	40	40	40	40	40	40	40
50	50	50	50	50	50	50	50	50	50	50
60	60	60	60	60	60	60	60	60	60	60
70	70	70	70	70	70	70	70	70	70	70
80	80	80	80	80	80	80	80	80	80	80
90	90	90	90	90	90	90	90	90	90	90
100	100	100	100	100	100	100	100	100	100	100
120	120	120	120	120	120	120	120	120	120	120
150	150	150	150	150	150	150	150	150	150	150
180	180	180	180	180	180	180	180	180	180	180
200	200	200	200	200	200	200	200	200	200	200
250	250	250	250	250	250	250	250	250	250	250
300	300	300	300	300	300	300	300	300	300	300
350	350	350	350	350	350	350	350	350	350	350
400	400	400	400	400	400	400	400	400	400	400
450	450	450	450	450	450	450	450	450	450	450
500	500	500	500	500	500	500	500	500	500	500
550	550	550	550	550	550	550	550	550	550	550
600	600	600	600	600	600	600	600	600	600	600
650	650	650	650	650	650	650	650	650	650	650
700	700	700	700	700	700	700	700	700	700	700
750	750	750	750	750	750	750	750	750	750	750
800	800	800	800	800	800	800	800	800	800	800
850	850	850	850	850	850	850	850	850	850	850
900	900	900	900	900	900	900	900	900	900	900
950	950	950	950	950	950	950	950	950	950	950
1000	1000	1000	1000	1000	1000	1000	1000	1000	1000	1000

Technical Specifications 工況範圍

- 適用管徑
- 適用管厚
- 適用管種
- 適用管壁

Qualification & Standards 符合規範和標準

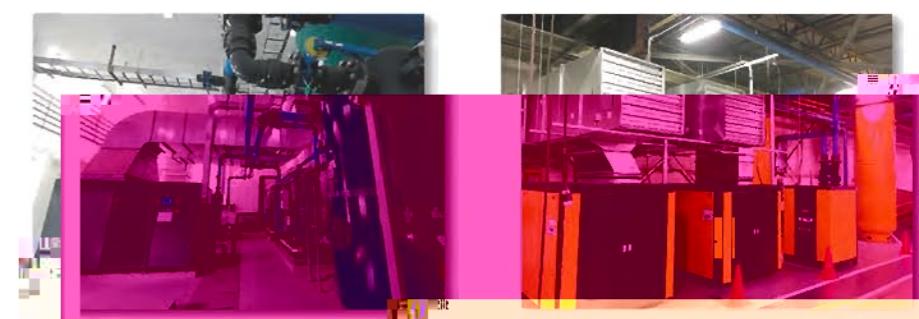

Engineered for Superior Performance 產品設計，只為最佳效能

we are at your **SERVICE**
我們始終在您的身邊

