

We provide superior
performing compressed air

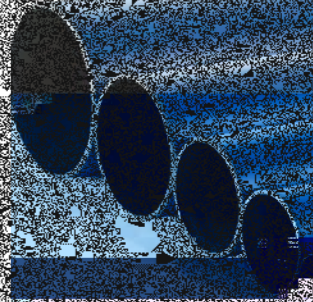

ENGINEERED BY RIDERINDUSTRIES.COM

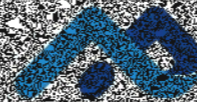

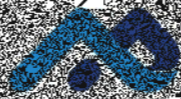
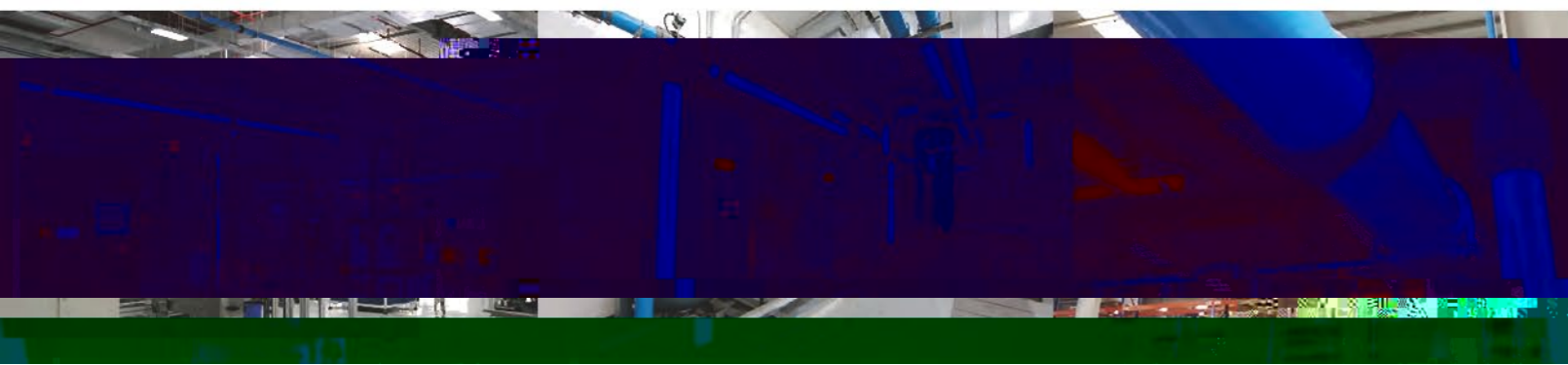
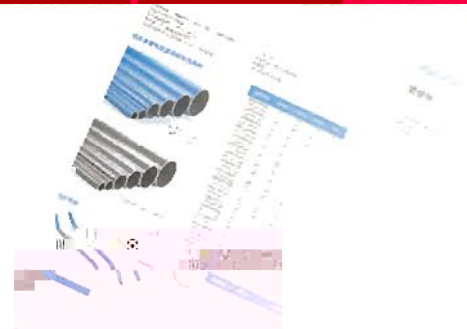
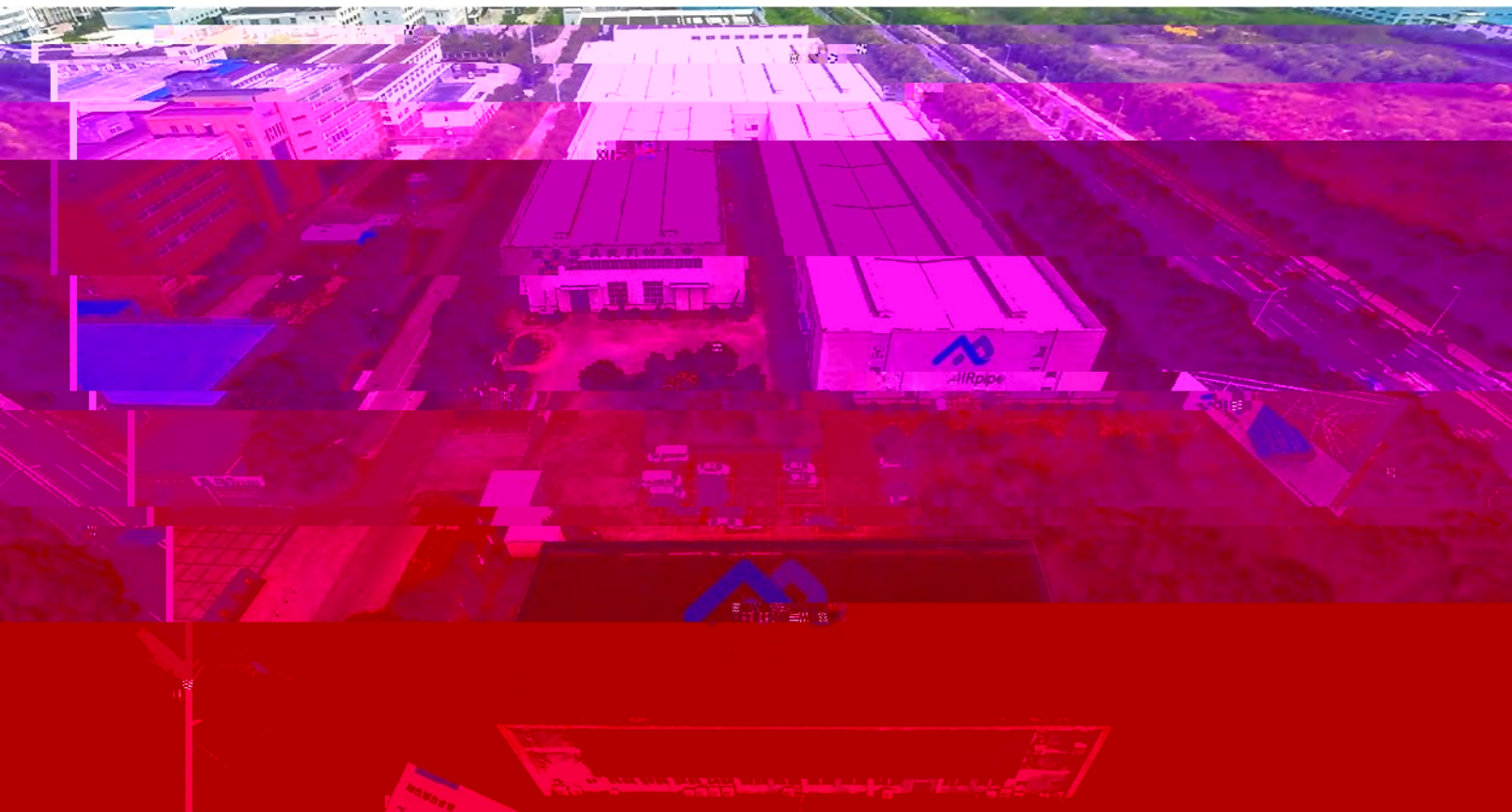

Superior Reliability & Longevity

-
- IV
-
- D



Energy & Cost Savings

-
- C

Quick & Easy Modular Installation

- C
-
- R
- C

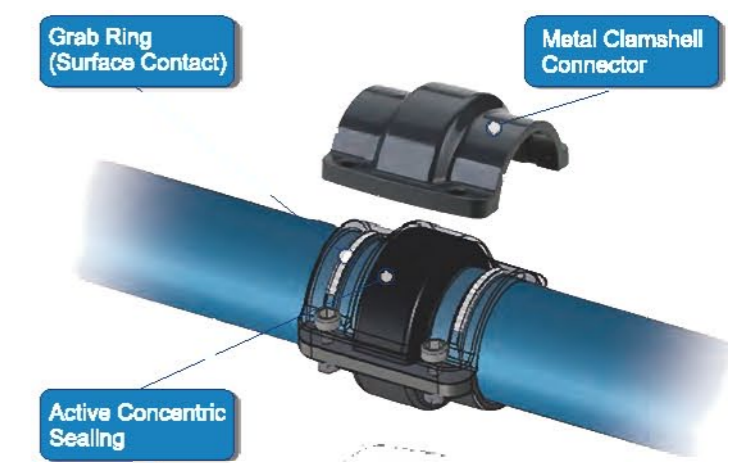

Dual Performance

- Surface contact and active sealing
- Working Pressure up to 16bar
- 20 year life

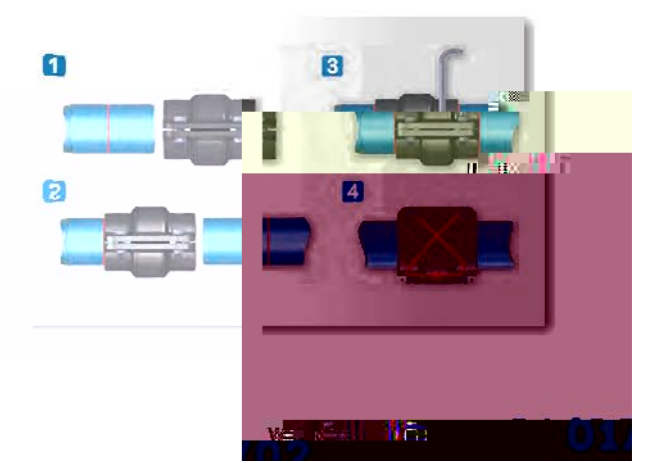
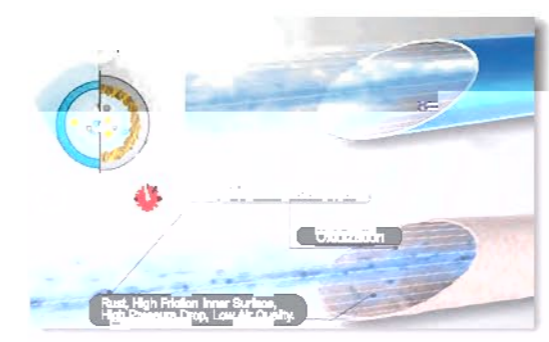

Product Range & Features

Poly Aluminum Pipe



-
-
-
-

Ball & Butterfly Valves



-
-
-
-

Pipe Connectors



-
-
-
-
-

Flexible Hoses



- S
- A
- R
- R

Quick Drop Fittings



-
-
-
-

Tools & Accessories



- S
- U
- D

BLUE ALUMINUM PIPE



GREEN ALUMINUM PIPE

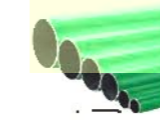

GRAY ALUMINUM PIPE



END CAP

EQUAL 90° ELBOW



EQUAL 45° ELBOW



REDUCING TEE



LATERAL REDUCING TEE



EQUAL PIPE TO PIPE CONNECTORS



EQUAL TEE



REDUCING PIPE TO PIPE CONNECTORS



LATERAL EQUAL TEE



ALUMINUM JOINT FEMALE TREAD

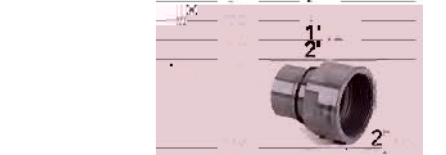

Superior Reliability!



Insertion Depth S For DN20-DN50 Connector

DN	Insertion depth S (mm)
50	29

Installation Guide for DN20-DN50

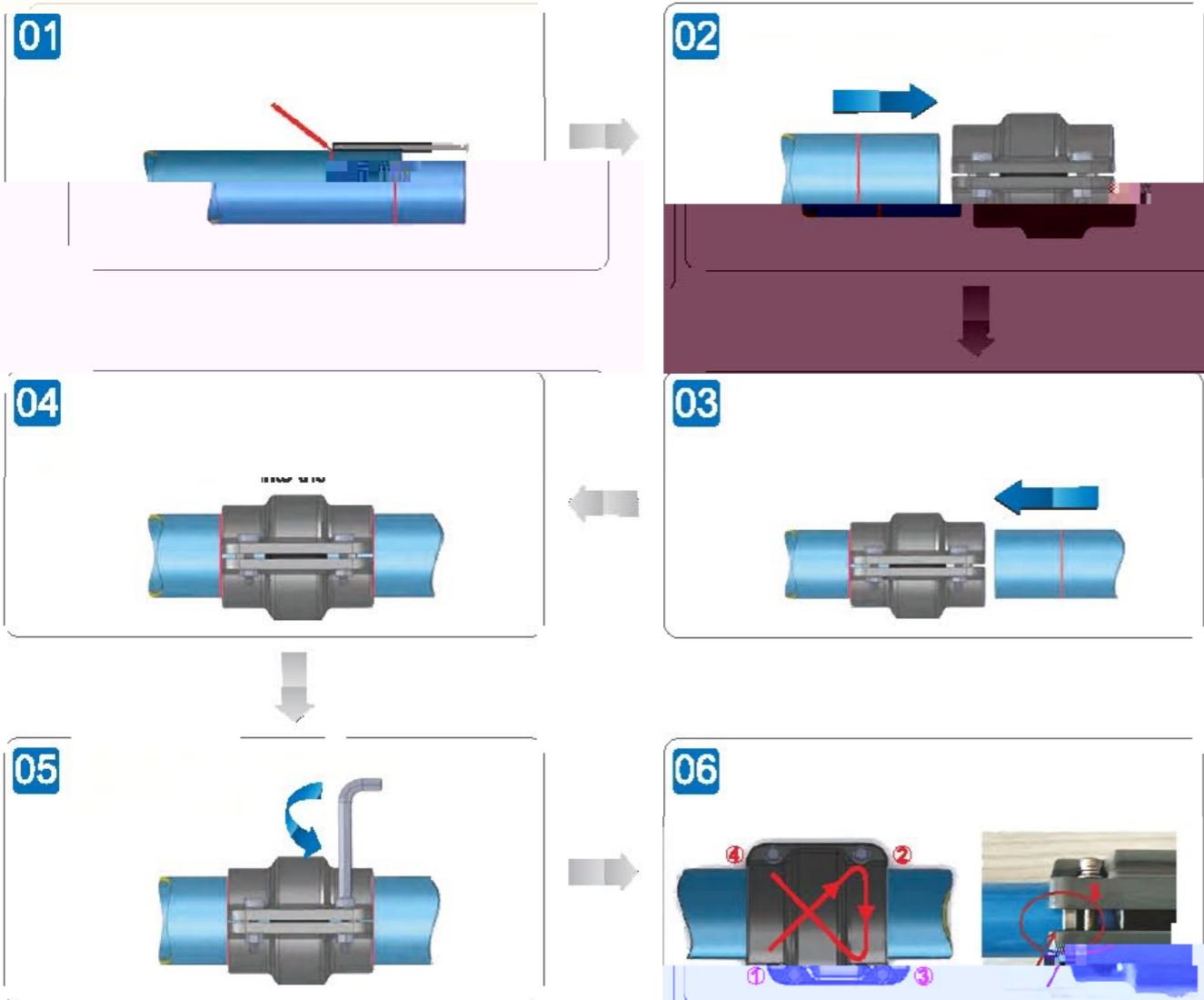

Deburr & Chamfer The Outer and Inner Edges Before Installation

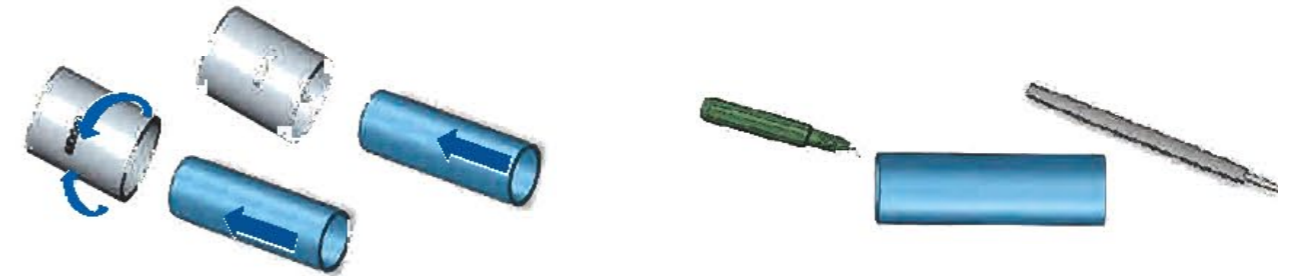

Installation Guide for DN63-DN200

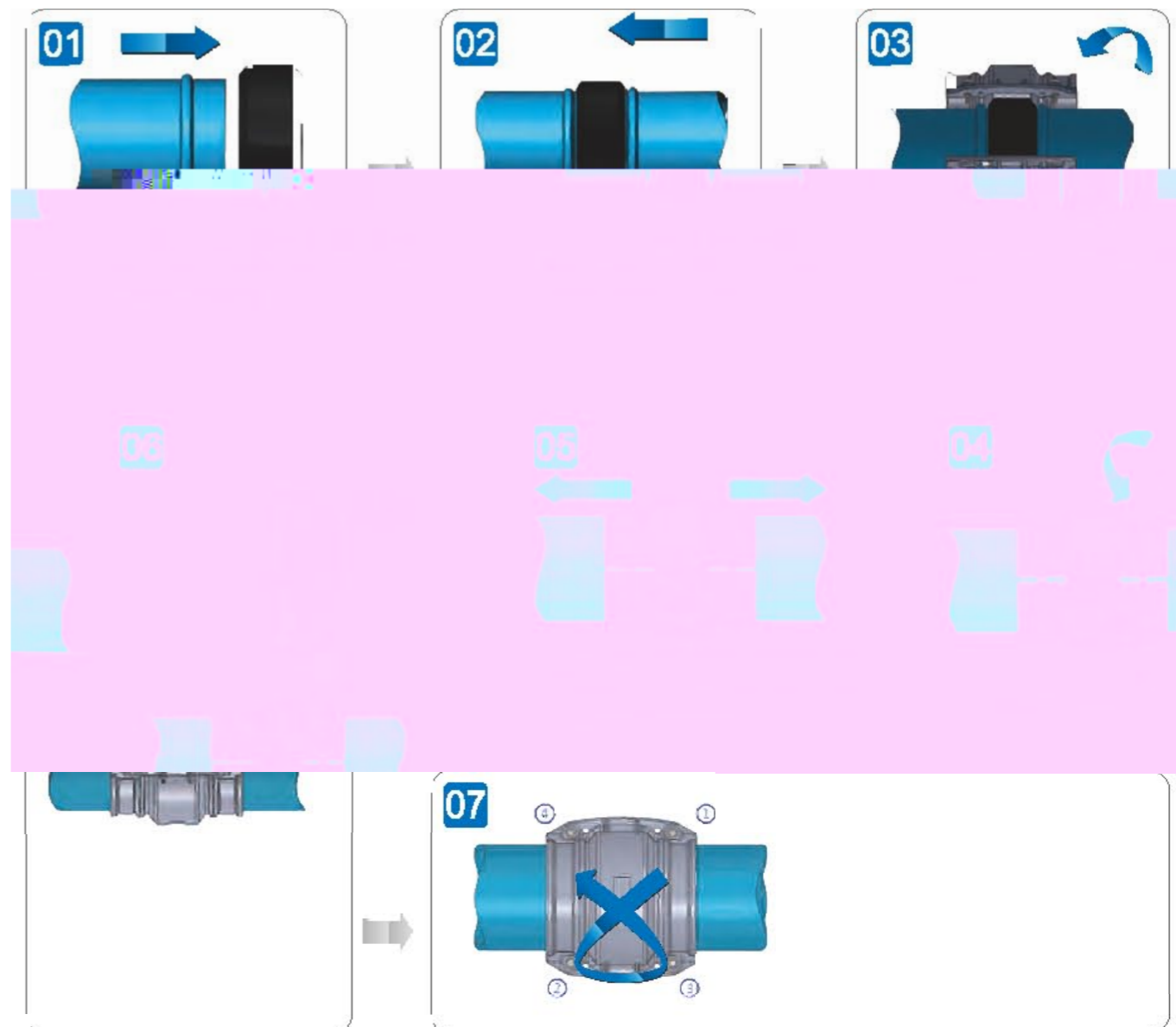

Hand-held hydraulic lugging machine operation requirements



Manually open the jaws of the clamp and insert the aluminum pipe into the clamp as far as possible.

Release the jaws. Press the trigger and crimp the pipe until a "snap" sound is heard.

Re-open the two jaws to remove the pipe and rotate the pipe slightly. Put the jaw side to the mark position.

Renew the operation until the required minimum number of lugs for each diameter is finished.

Number of lugs for each diameter:

AIRPIPE	DN63	DN80	DN100	DN150	DN200
	5	6	6	6	2

Note: Do not overlap the lug!

DN	H(mm)
63	3.0-3.3
80	3.0-3.3
100	3.0-3.3
150	3.0-3.3
200	3.0-3.3



Sizing Chart for Quick Drops

Drill	Drill Holder	Drill Bit	Drill Bit	Drill Bit	Drill Bit	Drill Bit	Drill Bit	Drill Bit	Drill Bit	Drill Bit
301 35 0005 01	301 35 0005 02	022	302 10 0401 04	302 10 0402 04	302 11 0403 03	302 10 0302 01	302 10 0701 01	302 10 0702 01		
			302 10 0801 01	302 10 0802 01	302 10 0801 01	302 10 1002 01	302 10 1102 01			
301 35 0005 01	301 35 0005 03	026	302 10 0801 01	302 10 0802 01	302 10 1001 01	302 11 0801 01	302 11 0700 01	302 11 0701 01		
			302 11 0500 01	302 11 0501 01	302 11 0800 01					
			302 11 0800 01	302 11 1000 01						
301 35 0005 02	301 35 0005 04	028	302 10 0804 01							
301 35 0005 02	301 35 0005 05	031	302 10 1004 01	302 10 1005 01	302 10 1104 01	302 10 1105 01				

- The following table is based on a closed-loop pipe system.
- Working pressure is 8bar and pressure drop is 0.4bar, flow speed not taken into account.

Flow N m ³ /h	Length									
	50M	100M	150M	300M	500M	750M	1000M	1300M	1600M	2000M
10	20	20	20	20	20	20	20	25	25	25
30	20	20	20	25	25	25	25	25	25	40
50	20	25	25	25	25	25	25	40	40	40
70	25	25	25	25	40	40	40	40	40	40
100	25	25	25	40	40	40	40	40	40	50
150	25	40	40	40	40	40	40	40	50	50
250	40	40	40	40	50	50	50	50	50	50
350	40	40	40	50	50	50	50	50	50	50
500	40	40	50	50	50	50	50	50	50	50
750	40	50	50	50	50	50	50	50	50	50
1000	50	50	50	50	50	50	50	50	50	50
1250	50	50	50	50	50	50	50	50	50	50
1500	50	50	50	50	50	50	50	50	50	50
1750	50	50	50	50	50	50	50	50	50	50
2000	50	50	50	50	50	50	50	50	50	50
2500	50	50	50	50	50	50	50	50	50	50
3000	50	50	50	50	50	50	50	50	50	50
3500	50	50	50	50	50	50	50	50	50	50
4000	50	50	50	50	50	50	50	50	50	50
4500	50	50	50	50	50	50	50	50	50	50
5000	50	50	50	50	50	50	50	50	50	50
5500	50	50	50	50	50	50	50	50	50	50
6000	50	50	50	50	50	50	50	50	50	50
6500	50	50	50	50	50	50	50	50	50	50
7000	50	50	50	50	50	50	50	50	50	50
7500	50	50	50	50	50	50	50	50	50	50
8000	50	50	50	50	50	50	50	50	50	50
8500	50	50	50	50	50	50	50	50	50	50
9000	50	50	50	50	50	50	50	50	50	50
9500	50	50	50	50	50	50	50	50	50	50
10000	50	50	50	50	50	50	50	50	50	50
10500	50	50	50	50	50	50	50	50	50	50
11000	50	50	50	50	50	50	50	50	50	50
11500	50	50	50	50	50	50	50	50	50	50
12000	50	50	50	50	50	50	50	50	50	50

Technical Specifications

- Max. working pressure: 15bar (-20°C ~ +80°C), 16bar (-20°C ~ +45°C)
Max. working pressure for DN200 is 13bar.
- Vacuum: 1mbar (absolute pressure).
- Working temperature: -20°C ~ +80°C.
- Suitable fluids: compressed air, oil-free or lubricated, wet, vacuum, inert gases.
- Fireproof and suitable for outdoor applications.

Qualification & Standards

2014/68/EU, ASME B31.1, TUV, GB/T4437.1-2000, EN755-8, TS, UIG4, ISO 8573-1



Engineered for Superior Performance

- We are committed to provide superior products and service.
- R&D is a continuous process linked to real-world conditions & market feedback.
- Always customer oriented, from design production to sales and service.

we are at your SERVICE

