

We provide superior
performing compressed air

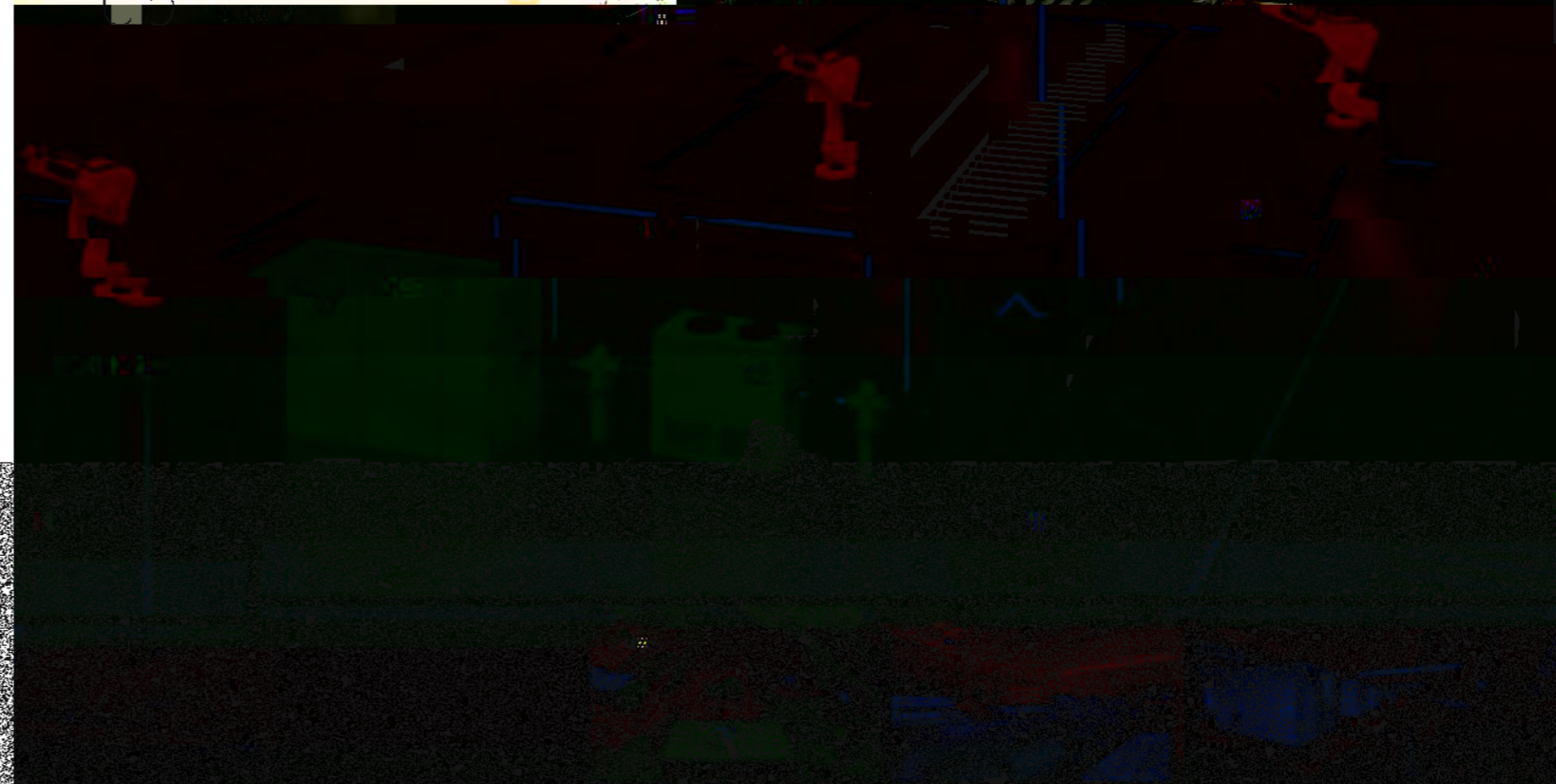

ENGINEERED FOR SLIDING

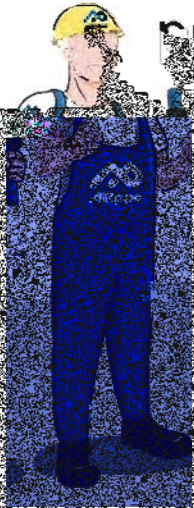

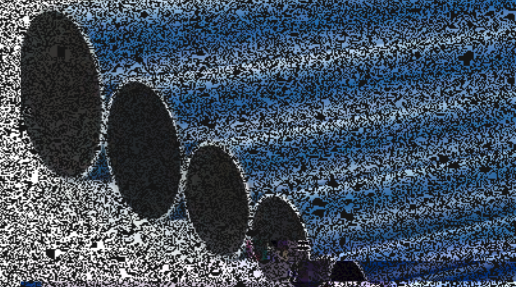
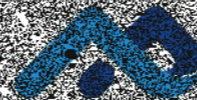
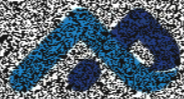
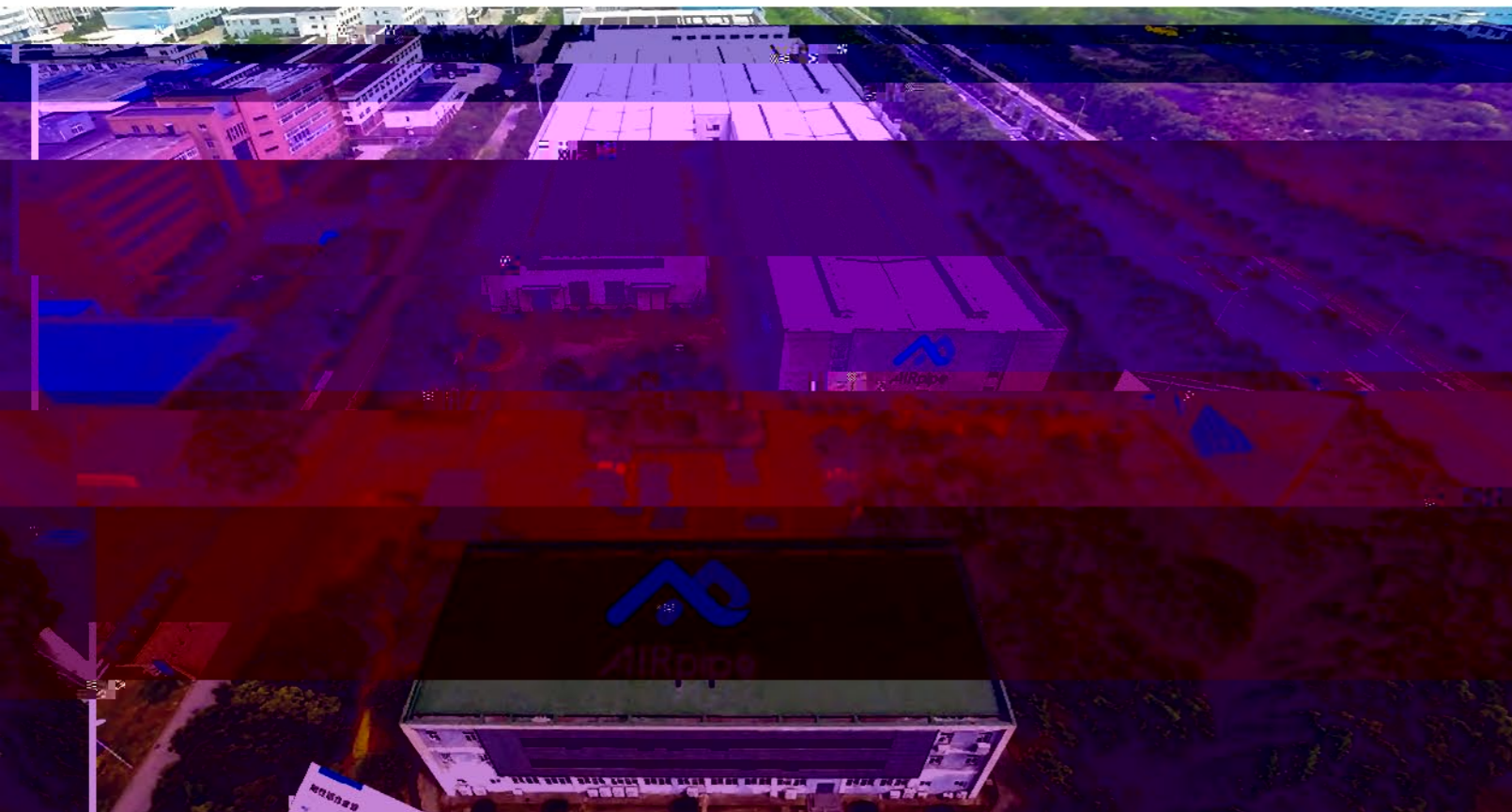

Superior Reliability & Longevity

-
-
-
-



Energy & Cost Savings

-
-

Quick & Easy Modular Installation

-
-
-
-

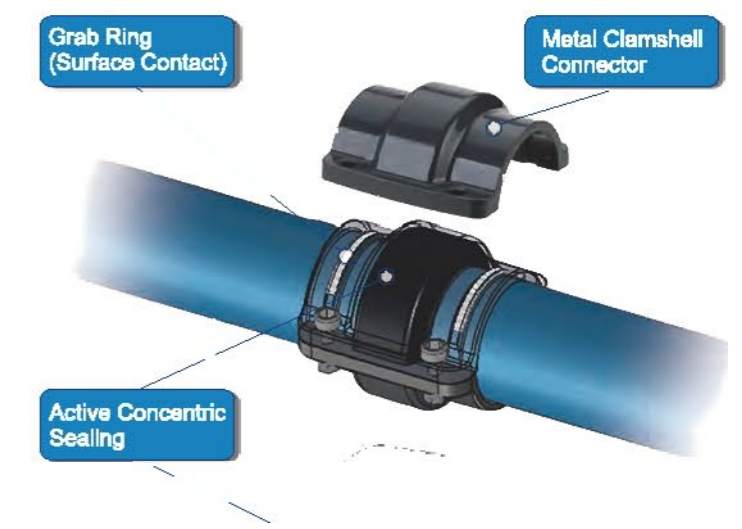

Dual Performance

- Surface contact and active sealing
- Working Pressure up to 16bar
- 20 year life

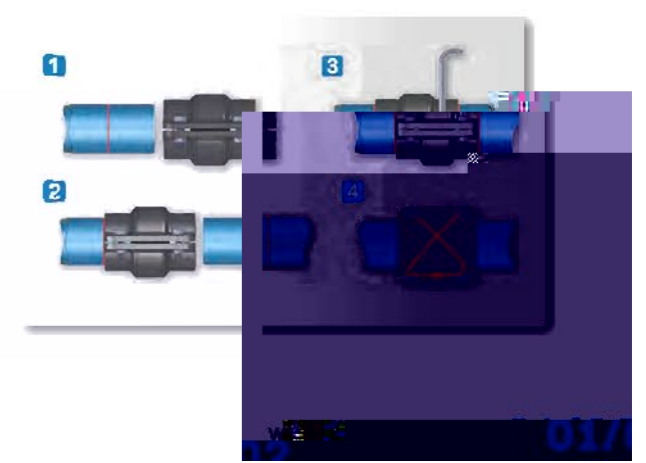
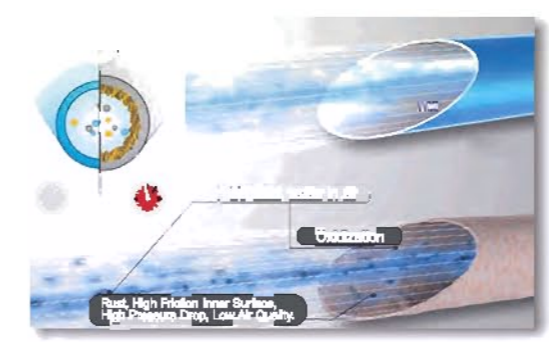

Product Range & Features

Plug Aluminum Pipe

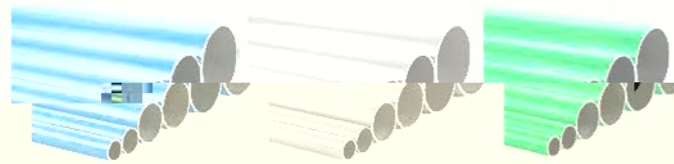

- Up to max.200mm diameter - 200m³/min flow single line.
- High-quality powder coating and colors customization.
- Designed for compressed air, vacuum, and inert gases.
- Light-weight & corrosion-free.

Pipe Connectors



Ball & Butterfly Valves



- Quick connection.
- Available for BSP/NPT thread, flange, plug-in connection type.
- High-flow design ensures optimal performance.

Flexible Hoses



BLUE ALUMINUM PIPE

5.8M Length

AIRpipe	DN	OD	ID
301 00 0100 01	20	20.1	17.5
301 00 0200 01	25	25.1	22.5
301 00 0400 01	40	40.1	38.5
301 00 0500 01	50	50.1	45.7
301 00 0600 01	63	67.6	63.0
301 00 0700 01	80	84.8	80.0
301 00 0800 01	100	101.8	96.8
301 00 0900 01	150	153.0	147.5
301 00 1000 01	200	205.0	197.8

* 2.9M length please contact local sales.

GREEN ALUMINUM PIPE

5.8M Length

AIRpipe	DN	OD	ID
301 00 0100 03	20	20.1	17.5
301 00 0200 03	25	25.1	22.5
301 00 0400 03	40	40.1	36.5
301 00 0500 03	50	50.1	45.7
301 00 0600 03	63	67.6	63.0
301 00 0700 03	80	84.8	80.0
301 00 0800 03	100	101.8	96.8
301 00 0900 03	150	153.0	147.5
301 00 1000 03	200	205.0	197.8

* 2.9M length please contact local sales.

EQUAL 90° ELBOW

AIRpipe	DN
302 03 0100 02	20
302 03 0200 02	25
302 03 0400 02	40

GRAY ALUMINUM PIPE

5.8M Length

AIRpipe	DN	OD	ID
301 00 0100 02	20	20.1	17.5
301 00 0200 02	25	25.1	22.5
301 00 0400 02	40	40.1	36.5
301 00 0500 02	50	50.1	45.7
301 00 0600 02	63	67.6	63.0
301 00 0700 02	80	84.8	80.0
301 00 0800 02	100	101.8	96.8
301 00 0900 02	150	153.0	147.5
301 00 1000 02	200	205.0	197.8

* 2.9M length please contact local sales.

END CAP

AIRpipe	DN
302 06 0100 02	20
302 06 0200 02	25
302 06 0400 02	40
302 06 0500 02	50

*Union connector included

302 06 0600 01	63
302 06 0700 01	80
302 06 0800 01	100
302 06 0900 01	150
302 06 1000 01	200

*Use one union connector

REDUCING TEE

AIRpipe	DN	DN
302 07 0201 02	25	20
302 07 0402 02	40	25

EQUAL PIPE TO PIPE CONNECTORS

AIRpipe	DN
32 02 0100 01	20
32 02 0200 01	25
32 02 0400 01	40
32 02 0500 01	50
32 02 0601 05	63
32 02 0701 08	80
32 02 0801 08	100
32 02 1001 05	150
32 02 1101 05	200

EQUAL TEE

AIRpipe	DN
02 05 0100 02	20
02 05 0200 02	25
02 05 0400 02	40
02 05 0500 02	50

Union connectors included

02 05 0600 01	63
02 05 0700 01	80
02 05 0800 01	100
02 05 1000 01	150
02 05 1100 01	200

Use three union connectors

REDUCING PIPE TO PIPE CONNECTORS

AIRpipe	DN	DN
302 21 0201 02	25	20
302 21 0402 02	40	25
302 21 0502 02	50	25
302 21 0504 02	50	40
302 21 0604 02	63	40
302 21 0605 02	63	50
302 21 0705 02	80	50

*Union connectors size below 63 included

302 21 0706 01	80	63
302 21 0808 01	100	63
302 21 0807 01	100	80
302 21 1007 01	150	80
302 21 1008 01	150	100

Superior Reliability!



Insertion Depth S For DN20-DN50 Connector

DN	Insertion depth S (mm)
50	29

Installation Guide for DN20-DN50

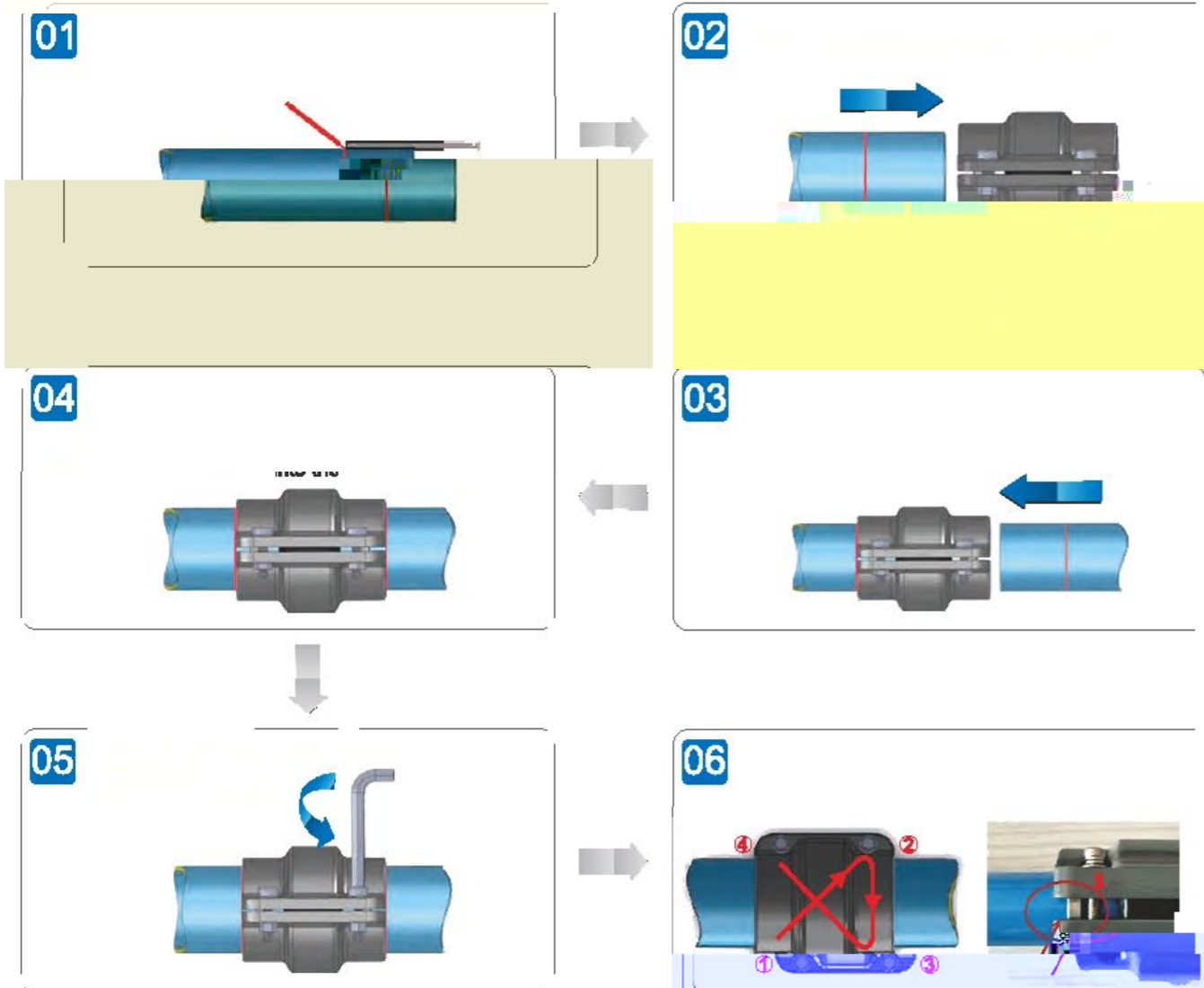

Deburr & Chamfer The Outer and Inner Edges Before Installation

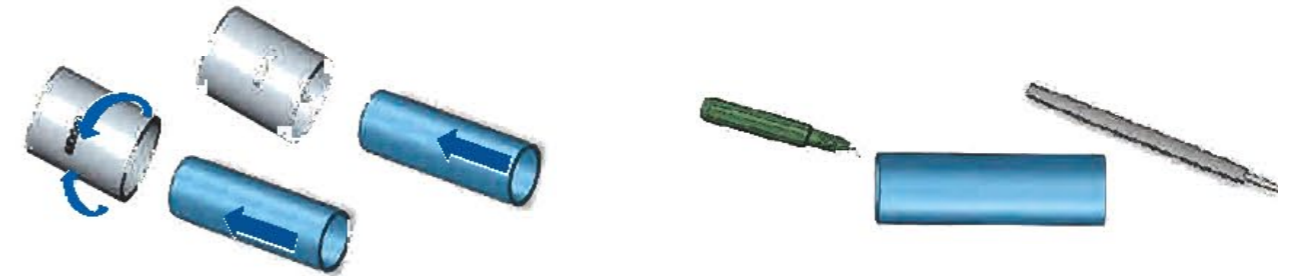

Installation Guide for DN63-DN200

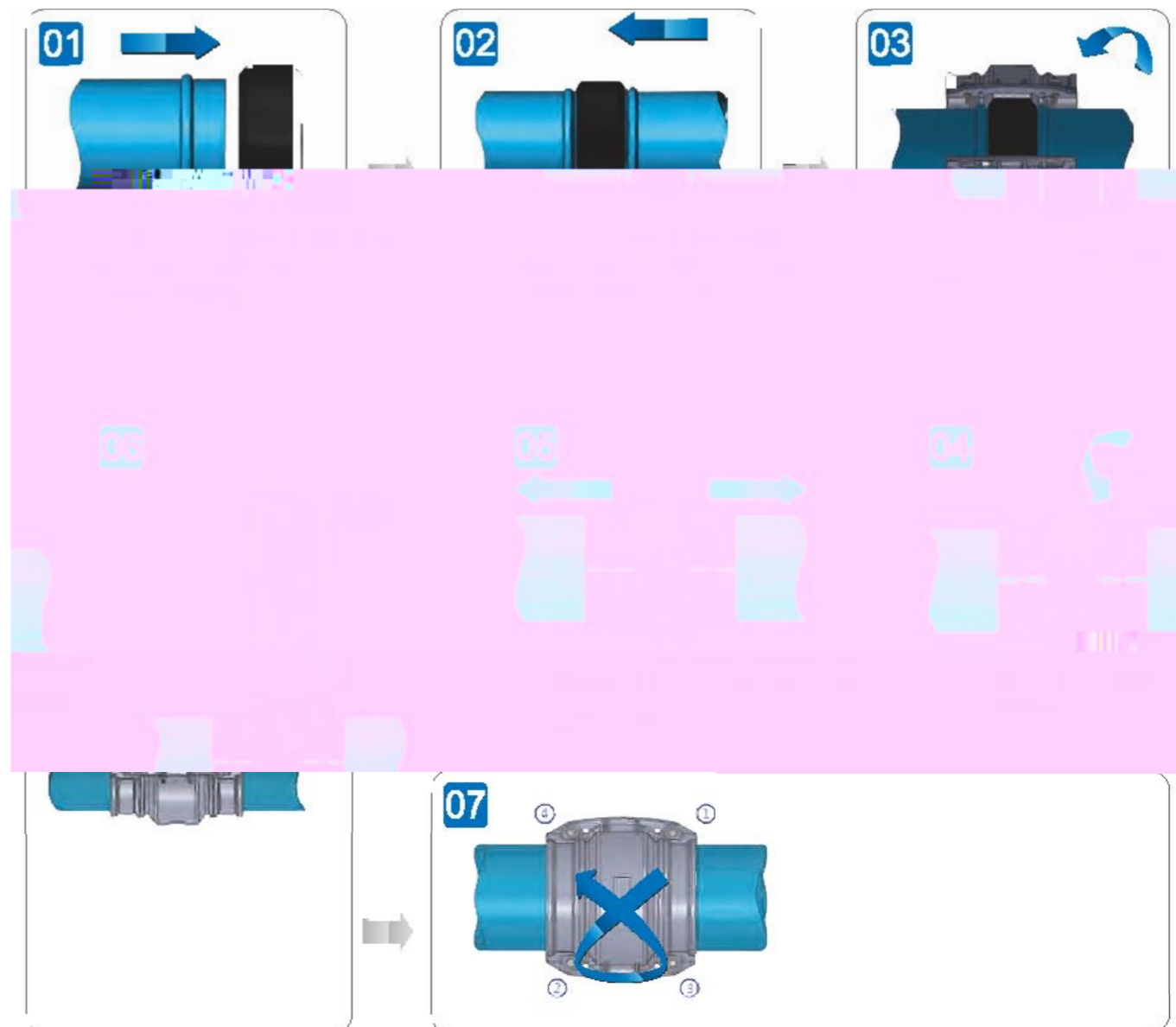

Hand-held hydraulic lugging machine operation requirements



Manually open the jaws of the clamp and insert the aluminum pipe into the clamp as far as possible.
 Release the jaws. Press the trigger and crimp the pipe until a "snap" sound is heard.
 Re-open the two jaws to remove the pipe and rotate the pipe slightly. Put the jaw side to the mark position.
 Renew the operation until the required minimum number of lugs for each diameter is finished.

Number of lugs for each diameter:

AIRPIPE	DN63	DN80	DN100	DN150	DN200
	5	6	6	6	2

Note: Do not overlap the lugs!

DN	H(mm)
63	3.0-3.3
80	3.0-3.3
100	3.0-3.3
150	3.0-3.3
200	3.0-3.3



Sizing Chart for Quick Drops

Drill	Drill Holder	DN(MM)	Quick Drops (PN)
301 35 0005 01	301 35 0008 08	Ø16	302 10 0201 04 302 10 0202 03 302 11 0200 03 302 11 0401 03
301 35 0005 01	301 35 0008 07	Ø22	302 10 0401 04 302 10 0402 04 302 11 0400 03 302 10 0602 01 302 10 0701 01 302 10 0702 01
			302 10 0801 01 302 10 0802 01 302 10 0801 01 302 10 1002 01 302 10 1102 01
301 35 0005 01	301 35 0008 03	Ø26	302 10 0801 01 302 10 0802 01 302 10 1001 01 302 11 0301 01 302 11 0700 01 302 11 0701 01
			302 11 0500 01 302 11 0501 01 302 11 0900 01
			302 11 0800 01 302 11 1000 01
301 35 0005 02	301 35 0008 04	Ø38	302 10 0804 01
301 35 0005 02	301 35 0008 05	Ø51	302 10 1004 01 302 10 1006 01 302 10 1104 01 302 10 1105 01

- The following table is based on a closed-loop pipe system.
- Working pressure is 8bar and pressure drop is 0.4bar, flow speed not taken into account.

Flow N m ³ /h	Length									
	50M	100M	150M	300M	500M	750M	1000M	1300M	1600M	2000M
10	20	20	20	20	20	20	20	25	25	25
30	20	20	20	25	25	25	25	25	25	40
50	20	25	25	25	25	25	25	40	40	40
70	25	25	25	25	40	40	40	40	40	40
100	25	25	25	40	40	40	40	40	40	50
150	25	40	40	40	40	40	40	50	50	50
250	40	40	40	40	50	50	50	50	50	50
350	40	40	40	50	50	50	50	50	50	50
500	40	40	50	50	50	50	50	50	50	50
750	40	50	50	50	50	50	50	50	50	50
1000	50	50	50	50	50	50	50	50	50	50
1250	50	50	50	50	50	50	50	50	50	50
1500	50	50	50	50	50	50	50	50	50	50
1750	50	50	50	50	50	50	50	50	50	50
2000	50	50	50	50	50	50	50	50	50	50
2500	50	50	50	50	50	50	50	50	50	50
3000	50	50	50	50	50	50	50	50	50	50
3500	50	50	50	50	50	50	50	50	50	50
4000	50	50	50	50	50	50	50	50	50	50
4500	50	50	50	50	50	50	50	50	50	50
5000	50	50	50	50	50	50	50	50	50	50
5500	50	50	50	50	50	50	50	50	50	50
6000	50	50	50	50	50	50	50	50	50	50
6500	50	50	50	50	50	50	50	50	50	50
7000	50	50	50	50	50	50	50	50	50	50
7200	50	50	50	50	50	50	50	50	50	50
8000	50	50	50	50	50	50	50	50	50	50
8500	50	50	50	50	50	50	50	50	50	50
10000	50	50	50	50	50	50	50	50	50	50
12000	50	50	50	50	50	50	50	50	50	50

Technical Specifications

- Max. working pressure: 15bar (-20°C~ +80°C), 16bar (-20°C~ +45°C)
Max. working pressure for DN200 is 13bar.
- Vacuum: 1mbar (absolute pressure).
- Working temperature: -20°C ~ +80°C.
- Suitable fluids: compressed air, oil-free or lubricated, wet, vacuum, inert gases.
- Fireproof and suitable for outdoor applications.

Qualification & Standards

2014/68/EU, ASME B31.1, TUV, GB/T4437.1-2000, EN755-8, TS, U194, ISO 8573-1

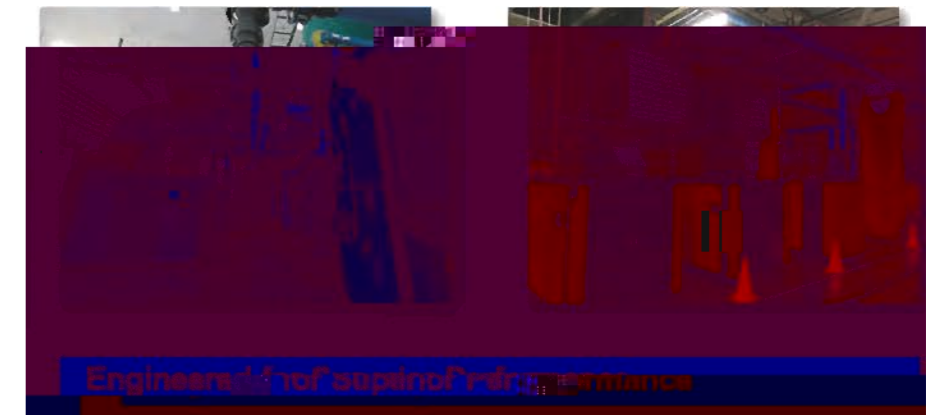

- We are committed to provide superior products and service.
- R&D is a continuous process linked to real-world conditions & market feedback.
- Always customer oriented, from design production to sales and service.



we are at your SERVICE

